

## STEAM VALVE - PRESSURE REDUCTION VALVE 921602

### Technologically advanced fluid control valve.

1. The patented self-aligning and shockabsorbing spherical piston holds the set pressure within  $\pm 0,1$  bar.
2. The valve is unaffected by varying primary pressure and fluctuating flow rates.
3. Major internal components of stainless steel.
4. Wide pressure range and large capacity.
5. Internal primary and secondary pressure sensing channels make external sensing lines unnecessary for most applications.

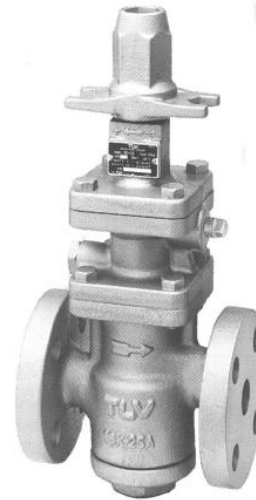

<b>Model</b>	<b>COSR-16</b>
Connection	Flanged
Size	DN15-DN150
Body material	Ductile Cast iron (GGG 40,3)
Operating Pressure (barg)	2-16
Maximum Operating Temperature (°C)	220
Pressure Adjustment Range (barg)	0,3-13,4
Maximum Reduction Ratio	10-84% (Maximum pressure differential must be less then 8 bar)
Minimum Adjustable Flow Rate	5% of rated flow rate DN65-DN150: 10% of rated flow rate

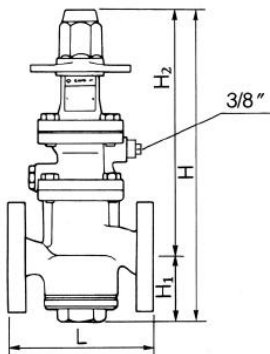

Flang Standard DIN 2501 PN 25/40.  
Other Flange Standards available

DN	L	H	H1	H2	Weight kg
15	130	367	72	295	10
20	150	367	72	295	11
25	160	360	75	285	13
32	180	395	86	309	19
40	200	395	80	315	20
50	230	425	100	325	27
65	290	538	126	412	57
80	310	538	126	412	58
100	350	607	185	422	87
150	480	817	275	542	20